



The Welsh approach to heritage interpretation

Wales within the United Kingdom



Population: 3 million

Land mass: 2 million hectares

20% speak Welsh



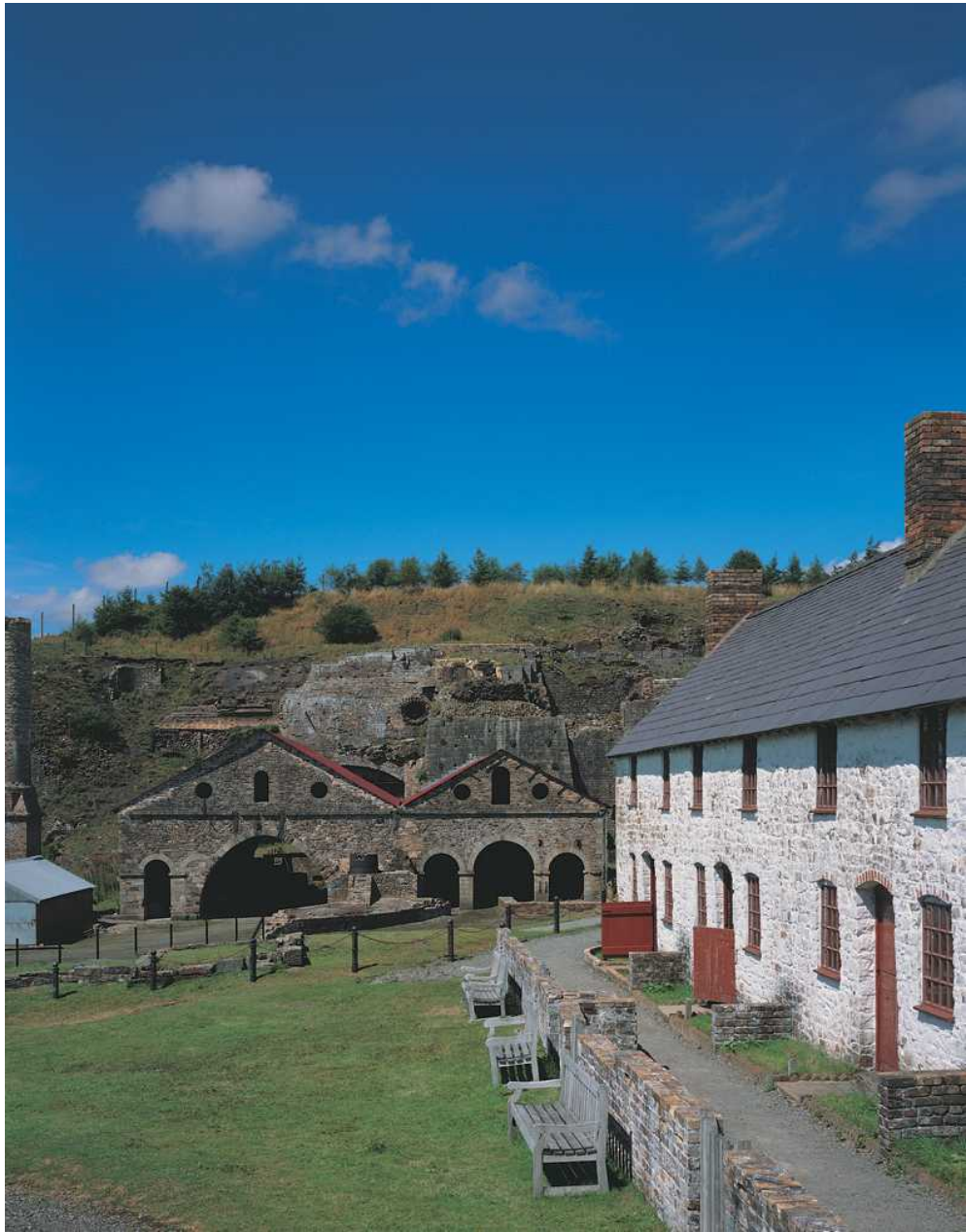







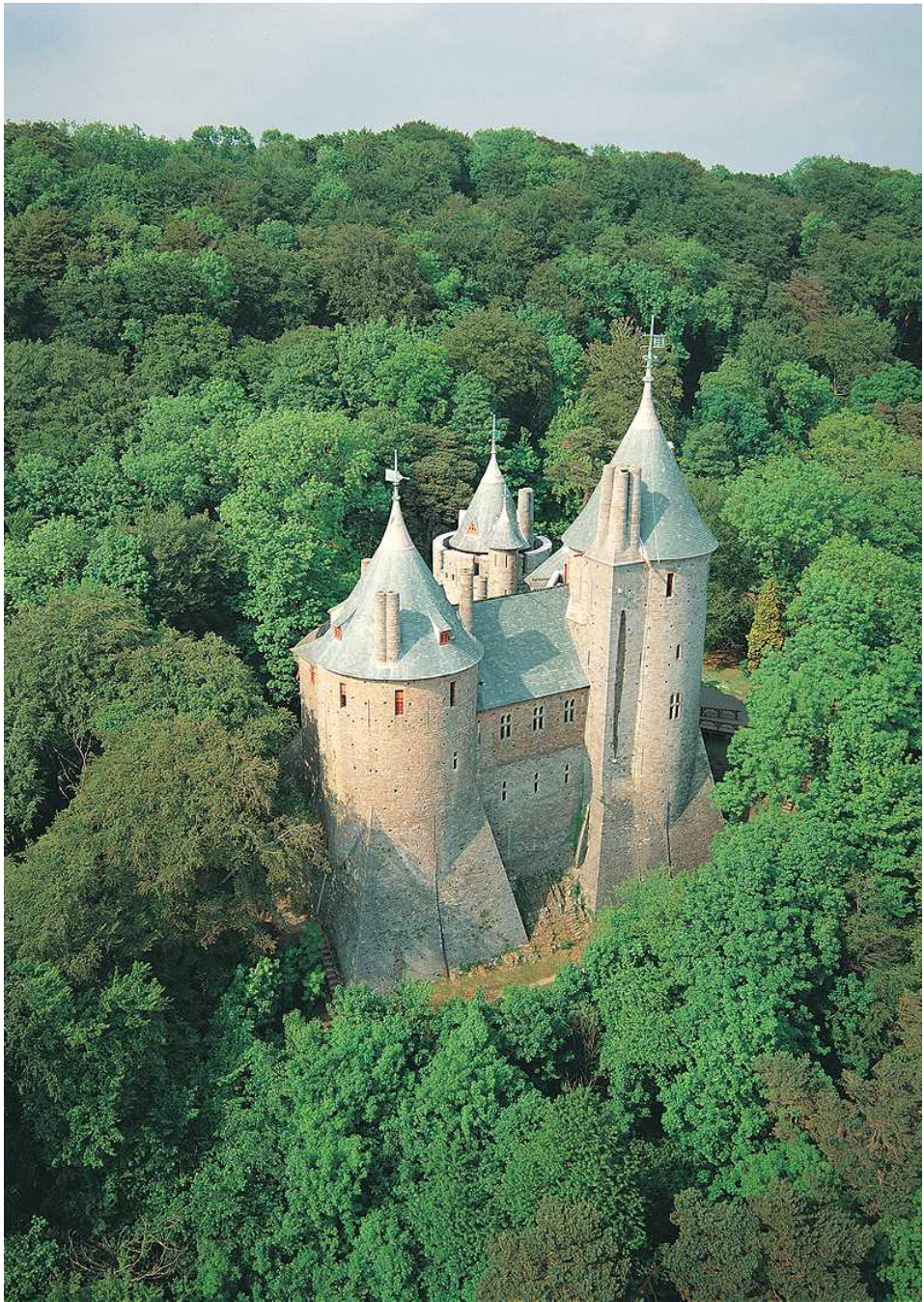





L LIGWY CHAPEL

This tiny early-12th-century church was a chapel of ease for the widespread community of Penros Lligwy whose parish church was too distant for some parishioners.

There was no separation between the nave and chancel and the walls were rendered and white washed. The bellcot and upper parts of the walls show some rebuilding in the 14th century, and a small chapel extension was added in the 16th century with a burial vault beneath.

The churchyard cross base behind you was moved inside for protection.

Roedd yr eglwys fach hon sy'n ddyldio o ddechrau'r 12^{ed} ganrif yn gapel amwes ar gyfer cymuned wasgaredig Penros Lligwy, yr oedd ei beltws blwyf yn rhy bell i rat plwyfolton.

Nid oedd unrhyw wabantad rhwng y corff a'r gangell ac roedd y muriau wedi'u rendro a'u gwyngulchu. Mae'r cwt cychbau a rhannau uchaf y muriau yn dangos rhywfaint o waith ailadeiladu yn y 14^{ed} ganrif, ac ychwaneguwyd estyntiad bach i'r capel yn y 16^{ed} ganrif, gyda chrosgell gladdu oddi tano.

Symudwyd sylfaen croes y fynwent, y tu ôl i chi, i'r tu mewn i'r capel er mwyn ei diogelu.

Adrián's impression, partly cut away, showing the shape in the 16th century when the extension had been added. Original walls shown in shades of orange, y tu ôl i'r capel yn y 16^{ed} ganrif pan oedd y wabantad wedi'i ychwanegu.



HEN CAPEL LLUGWY



Cadw vision:

‘an accessible, well protected historic environment’

‘people enjoying and using the monuments’

Current issues:

- * Inaccessibility of sites - conservation, logistics of access, awareness
- * Dated and intellectually daunting interpretation
- * Insufficient provision for family visit

Current issues:

- * Unappealing visitor environment
- * Insufficient interpretation of the Welsh perspective/s
- * Over-focus on facts and powerful people

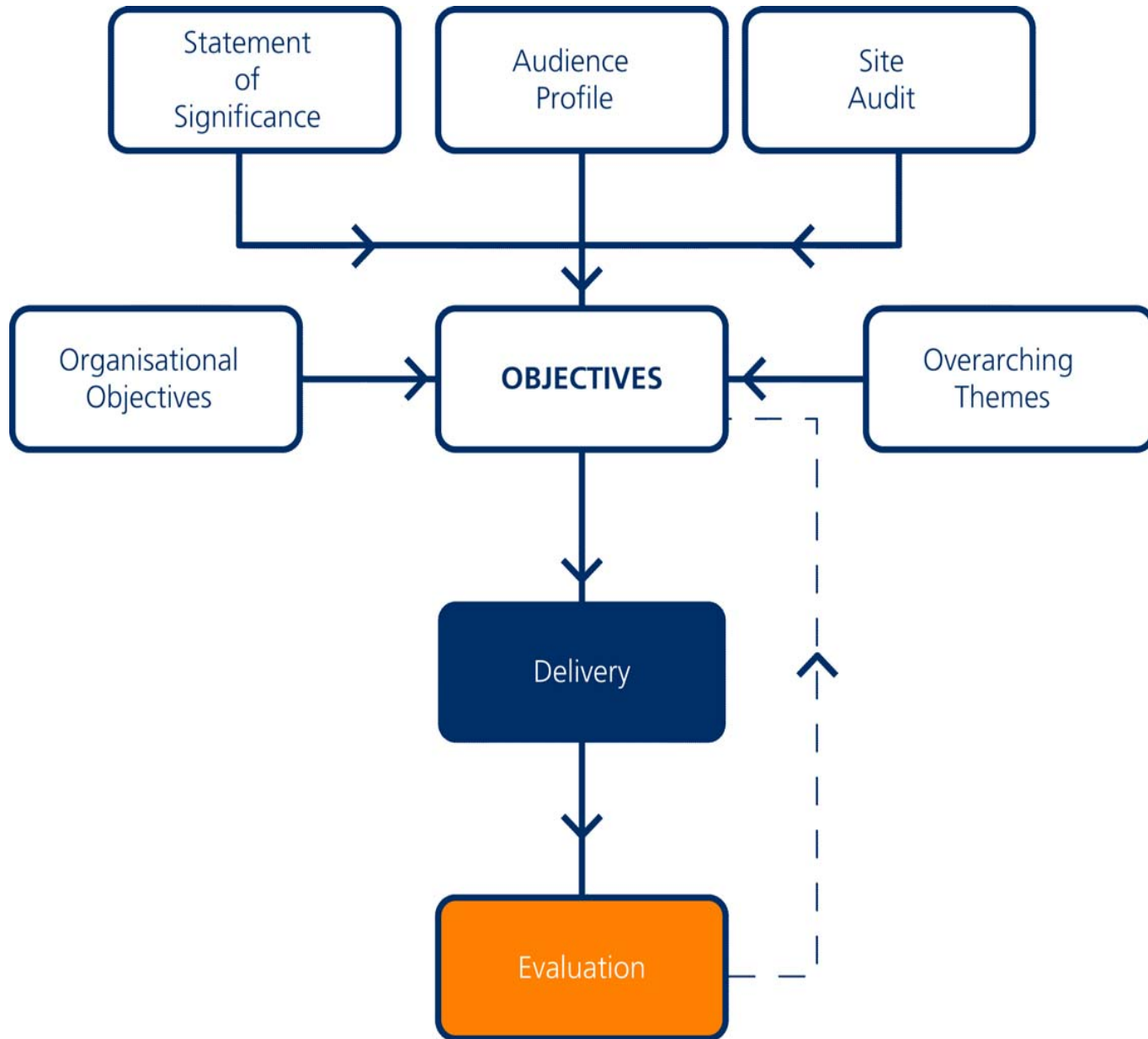

Community Profile for Chepstow Castle

Draft Version 1.0



Prepared by:
Dr Sharon Collins & Helen Begum
Evidence Base Ltd

February 2008

Residents Profile

This section provides a statistical profile for residents living in Chepstow. Unless otherwise specified, the figures provided in this profile are for the combined area of Chepstow's five wards; an area that is coterminous with the Chepstow Town Council area.

Chepstow is located within the following administrative boundaries:

- Chepstow Town Council Area, referred to in this profile as 'Chepstow town'
- The wards of St Mary's, St Christopher's, Larkfield, St Kingsmark and Thornwell.
- Seven Lower Level Super Output Areas (LSOAs):
 - Monmouthshire 007C (St Kingsmark 1)
 - Monmouthshire 007D (St Kingsmark 2)
 - Monmouthshire 008A (Larkfield)
 - Monmouthshire 008B (St Christopher's)
 - Monmouthshire 008C (St Mary's)
 - Monmouthshire 008D (Thornwell 1)
 - Monmouthshire 008E (Thornwell 2)
- Monmouthshire Local Authority Area



Deprivation Indicator	M'shire 007C St Kingsmark 1 Rank	M'shire 007D St Kingsmark 2 Rank	M'shire 008A Larkfield Rank	M'shire 008B St Christopher's Rank	M'shire 008C St Mary's Rank	M'shire 008D Thornwell 1 Rank	M'shire 008E Thornwell 2 Rank
Overall	1671	1761	1481	1300	1437	744	1451
Income	1872	1776	1343	1163	1347	444	1427
Employment	1690	1764	1595	1496	1325	1242	1602
Health	1132	1362	1364	1480	1312	1055	1535
Education Skills & Training	1611	1651	1095	817	1524	408	846
Housing	1892	1821	1390	1273	464	1339	1118
Physical Environment	1449	563	120	185	80	658	546
Geographic Access to Services	1393	686	1064	806	1667	706	512



Interpretation Planning: The Historic Environment of Wales	
Statement of Significance & Interpretation Framework	
St David's Bishop's Palace	Date of Visit 04.07.07
Part 1: Summary Overview	
<p>Overview</p> <p>St Davids Bishop's Palace is a building of exceptional architectural quality and historical significance. Interpretative provision is already high - the extent of covered space has allowed the installation of two exhibitions that explore its history, architecture and role of the bishops, and more recently a new exhibition has been installed to explain the recent conservation works. There is also an excellent guidebook. However, the exhibitions are beginning to date and visitor welcome and orientation, as well as opportunities for active learning, need to be reconsidered.</p> <p>Although situated within the City of St David's, the most prominent tourist destination in Pembrokeshire, the monument has seen a considerable decline in visitor figures over the last 10 years. It also experiences a high proportion of 'turn-away' visitors – those who find their way to the entrance but do not actually come in – and receives very few school visits. It has, however, been recently subject to a high level of investment in detailed conservation. The challenge therefore is to match this investment with a return to higher visitor figures and a more prominent role in the community life of St Davids.</p>	

Key themes:

- * Key theme 1: *History happened here* - key archaeological or historical period or event significant to the development of the property or surrounding geographical area
- * Key theme 2: *I lived here* - the stories of people, either known individuals or those whose lives can be traced through the archaeological and/or architectural record

Key themes:

- * Key theme 3: *Look here* - challenging visitors to look and ask questions of the archaeological, architectural and landscape evidence
- * Key theme 4: *We care* - helping people value their heritage and the role of conservation



Ydych chi'n defnyddio Bluetooth?

Helo a chroeso i'r heneb hon, un o lawer o dan ofal Cadw, gwasanaeth amgylchedd hanesyddol Llywodraeth Cynulliad Cymru.

Rydym yn chwilio am fyrrdd newydd o wneud ein safleoedd yn fwy diddorol o hyd.

Ar hyn o bryd rydym yn profi rhai o'n syniadau. A allwch ein helpu!

Un o'n syniadau yw defnyddio eich fflôn symudol i anfon gwybodaeth ychwanegol atoch. Mae gennym stori i'w hadrodd am y safle hwn. Os oes gennych Bluetooth, gallwn ei hanfon atoch ar unwaith – ac ni fydd yn costio ceiniog i chi.

Dilynwch y cyfarwyddiadau isod.

Os oes gennych Bluetooth ar eich fflôn symudol, dylech ei ddewis nawr. Etalai i bydd angen i chi ddod o hyd i 'settings', yna 'connection' – yna dylech weld eicon 'Bluetooth'. Dewiwch yr eicon a thro'u p. ar Bluetooth ymlaen – etalai i bydd angen i chi sicrhau bod eich fflôn yn 'discoverable', hefyd. Arhoswch am yd – aonir fflôn sain atoch yn awtomatig (etalai i bydd angen i chi ddewis 'accept' i dderbyn y fflôn ar eich fflôn symudol).

Gwrandewch ar y fflôn a gadewch i ni wybod sut hwyl a gewch. Mae dery flurdd i chi gwybhu à ni.

I Atabwch y cwestiynau ar y daflen 'Ydych chi'n defnyddio Bluetooth?' Mae rhan o'r daflen hon yn hollbar byr – cynnwys y cyfolyg o amser i'w gwblhau, torrwch yr hollbar isod ar y daflen a'5 hystio yn y bwrdd a ddarparir.

Diolch.

2. Ar y ddydd y cyhoeddiwyd: Gallwch foneuoddi ar ein hollbar anaf yn www.cadw.wales.gov.uk. Rhoddi cyfnewid y wefan ar ddiwedd y fflôn sain rydych wedi'i lawerhystio hefyd. (Etalai i byddwch am gadw'r fflôn sain i'ch atgoffo o'r cyfnewid ar ôl mynd gartref).

Do you Bluetooth?

Hello and welcome to this ancient monument, one of many looked after by Cadw, the Welsh Assembly Government's historic environment service.

We are constantly searching for new ways to make our sites more interesting.

At the moment we are testing some of our ideas. Can you help us please?

One of our ideas is to use your mobile phone to send you extra information. We have a story to tell you about this site. If you have Bluetooth, we can send it to you right now – and it won't cost you a penny.

Just follow the instructions below:

If you have Bluetooth on your mobile phone, turn it on now.

You may need to find your way to 'settings', then 'connection' – you should then see the 'Bluetooth' icon. Select the icon and turn Bluetooth power on – you may also need to make sure your phone is 'discoverable'. Wait a moment – you will automatically be sent a sound file (you may need to 'accept' the file on your mobile phone).

Listen to the file and let us know how you get on.

There are 2 ways for you to get in touch.

1. Answer the questions on the 'Do You Bluetooth?' leaflet. Part of this leaflet is a short questionnaire – please take a moment to fill it in, tear it off and post it in the box provided.

Thank you.

2. On the internet: You can log onto our online questionnaire at www.cadw.wales.gov.uk. The website address will also be given at the end of the sound file you have downloaded. (You may want to keep the sound file to remind yourself of the address when you get home).







THE THREE FATES

The most dramatic scene of the Drawing Room is the cycle of life, moving from earth (birth and life) to heaven (death). The focus is the chimney-piece where the figures of the Three Fates from Greek Mythology weave the thread of destiny that controls human life.



The Three Fates are depicted in the chimney-piece of the Drawing Room, where they weave the thread of destiny that controls human life.







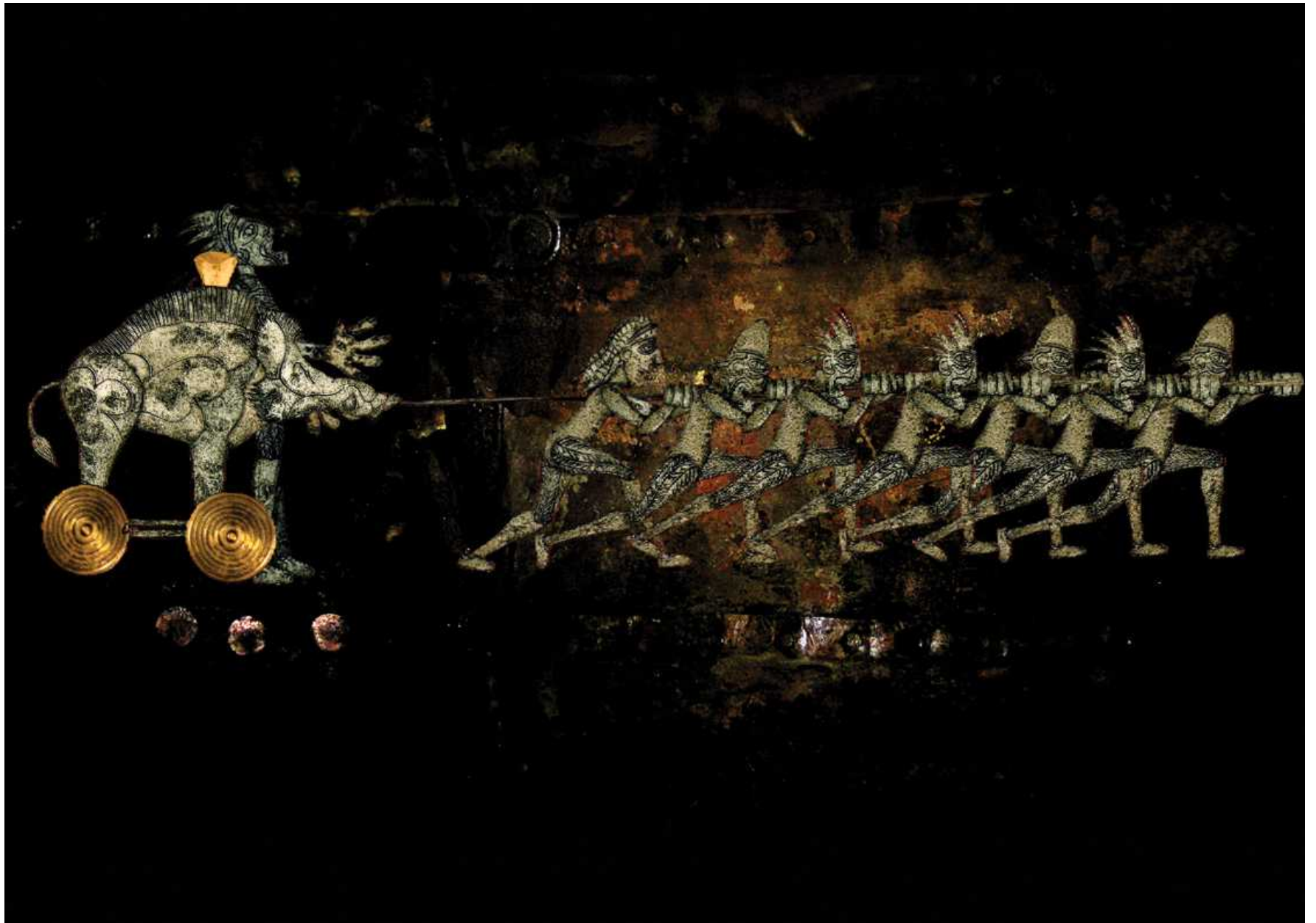

Cadwraeth ar Waith Conservation in Action



Croeso i Abaty Llandudoch

Beth sy'n digwydd a pham?

Mae Cadw a Hanes Llandoch yn falch o gyhoeddi y caiff canolfan ymwelwyr ei hadelladu yn Abaty Llandudoch. Ymddiheurwn i'n hymwelwyr am unrhyw darfu dros dro yn ystod y gwaith adeiladu. Mae adfeilion yr abaty ar agor o hyd a gellir ymweld â hwy am ddim.

Yr Hen Gerbyty

Mae'r Hen Gerbyty yn adeilad rhestredig gradd II sy'n dyddio o ganol y bedwaredd ganrif ar bymtheg, a chaff ei adnewyddu i greu canolfan ymwelwyr a fydd yn adrodd hanes Abaty Llandudoch a'r ardal gyfagos (1).

Bydd yr Hen Gerbyty yn gartref parhaol i nai o'r gweithiau cerrig cerfiedig ac addurnedig a ganfuwyd wrth wneud gwaith cloddio yn yr abaty gan gynnwys corbelau cerrig (2 a 3), delw beddrod a rhan o arcôd cloestr. Bydd hwn hefyd yn gartref i bedair croes Gristnogol Gynnar (4) sy'n dyddio o adeg cyn adeiladu'r abaty.

Welcome to St Dogmael's Abbey

What's happening and why?

Cadw and Hanes Llandoch are pleased to announce the construction of a visitor centre at St Dogmael's Abbey. We apologize to visitors for any temporary disruption during the construction work. The abbey ruins remain open and are free to visit.

The Old Coach House

The Old Coach House, a grade II listed building dating from the mid-nineteenth century, is being renovated to create a visitor centre that will tell the story of St Dogmael's Abbey and the surrounding area (1).

The Old Coach House will provide a permanent home for some of the carved and decorative stonework recovered from excavations of the abbey, including stone corbels (2 & 3), a tomb effigy and a section of cloister arcade. Also to be housed here are four Early Christian crosses (4) which pre-date the construction of the abbey.

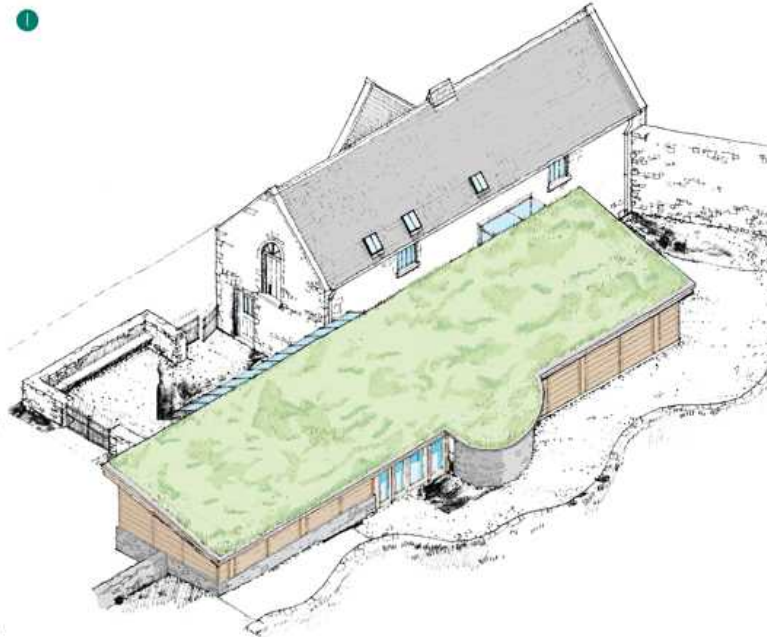

- 1 Llyn arlunydd o'r ganolfan ymwelwyr newydd
- 2 Corbel ar ffurf Eryr Sant Ioan (a oedd yn wreiddiol yn adain y gogledd)
- 3 Corbel addurnedig ar ffurf pen
- 4 Croes Gristnogol gynnar

- 1 Artist's drawing of the new visitor centre
- 2 Corbel bearing the Eagle of St John (originally in the north transept)
- 3 Decorative corbel in the shape of a head
- 4 Early Christian cross

